

Fischbach Land Company



Fischbach Land Company
510 Vonderburg Dr., Suite 302
Brandon, FL 33511
813-540-1000

Carlton Lake Road Home with 21 Acres, Wimauma, FL
Mature Oaks, Meandering Creek, and Plenty Of Pastureland!

FischbachLandCompany.com/Carlton21

Reed Fischbach
reed@fischbachlandcompany.com
Melissa Raburn
melissa@fischbachlandcompany.com

Quiet country home on 21 acres with mature oaks, meandering creek, and plenty of pastureland. Property offers privacy for the spacious home tucked back off the road, along with a beautiful conservation buffer. The 2,272 SF remodeled home has 3 BR/2 BA, popular open plan, office, foyer, and Florida room. The open-air barn and utility sheds offer plenty of room for toys and critters, along with several fenced pastures. This home will welcome you and all of your outdoor adventures!

Property Type: Home with Acreage

County: Hillsborough

Acreage: 20.55 +/- acres

Sale Price: \$560,000

Property Address: 15655 Carlton Lake Road, Wimauma, FL 33598

Nearest Intersection: Carlton Lake Road and Sweet Loop Road

Road Frontage: 15 +/- feet on Carlton Lake Road

Water Onsite: Creek

Soil Types: Fort Meade, Winder, and Zolfo Fine Sands

Fencing: Field fence

Utilities: Well and septic on site

Electric: TECO

Zoning: AR (1 home per 5 acres)

Future Land Use: AR

Property Uses: Home with acreage, farm

S-T-R: 31-31-21

Folio/PIN: 088723-0000

Property Taxes: \$1,990

Site Improvements:

- 2,272 SF Home, 3BR/2BA
- Two utility sheds
- Metal building



Remodeled Home!
Ideal Family Home with Plenty of Acreage!

Lots of Privacy
Spacious Home with Pasture
Bring Your Critters and Toys!
Close to City Conveniences and Amenities
Dining, Shopping, Entertainment, and Healthcare



Recently Remodeled, Gorgeous Open Plan!

**Beautiful Hardwood Floors and Finishes
French Doors, Hardwood Cabinets**



2,272 SF Remodeled Home with Beautiful Open Plan

Enter through the front door into a warm and inviting main living area, where a fireplace and built-in cabinets grab your attention. In addition to the three bedrooms and 2 baths, there is an office off the front foyer and a Florida room at the rear with beautiful views of the back pasture and wooded creek.

Updated Kitchen

The recently updated kitchen includes:

- Granite counter tops,
- Built-in oven
- Pantry closet

The spacious kitchen opens into the living and dining area for the sought-after open floor plan design.

Master Suite

The master suite encompasses a remodeled bathroom with:

- Subway tile
- Garden tub,
- Shower stall
- Walk-in closet



Outside you'll find:

- Open-air barn with plenty of rustic charm for entertaining
- Several fenced pastures
- Two utility sheds
- Plenty of room for toys and critters!

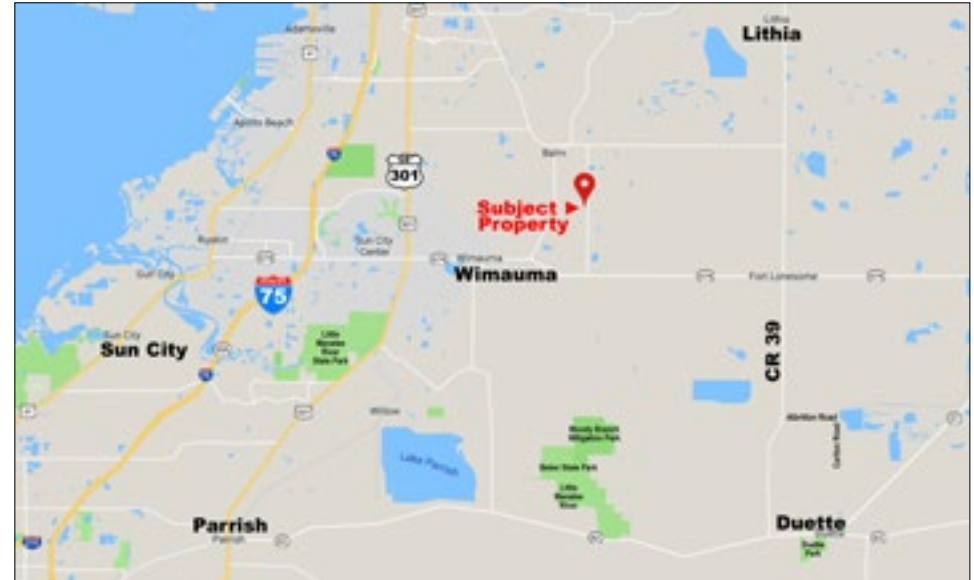

Centrally Located!

Minutes to I-75, US 301, Brandon, and Tampa

Assigned Schools:

- Wimauma Elementary School
- Shields Middle School
- Lennard High School

GPS: 27°44'18.80"N, - 82°14'40.86"W

Directions to Property From US 301:

- Go east on Balm Road/CR 672 (5.9 mi)
- Turn right (south) onto Carlton Lake Road (1.7 mi)
- Arrive at destination on the right