



Fischbach
LAND COMPANY

**WIMAUMA
RANCHETTE**

5.43± ACRES

Property Overview

Build your dream home on this high and dry 5.43 acres in an ideal country setting, surrounded by custom home estates, state preserve land, and farmland. Enjoy keeping your horses on your property while just 10 minutes from the riding trails of Alafia River State Park, 10 minutes from the Balm Boyette Scrub Nature Preserve, and 20 minutes to the Little Manatee River State Park. Embrace the serenity of the country while just 15 minutes from Sun City Center and the I-75 on ramp, and 5 minutes from CR 39 which takes you directly in to Lithia, Plant City, and I-4.



www.FischbachLandCompany.com/WimaumaRanchette5.43±Acres

Property Highlights



Just 15 Minutes to Sun City Center and I-75



High and Dry, Elevation Change of 10 Feet



Close proximity to State Parks

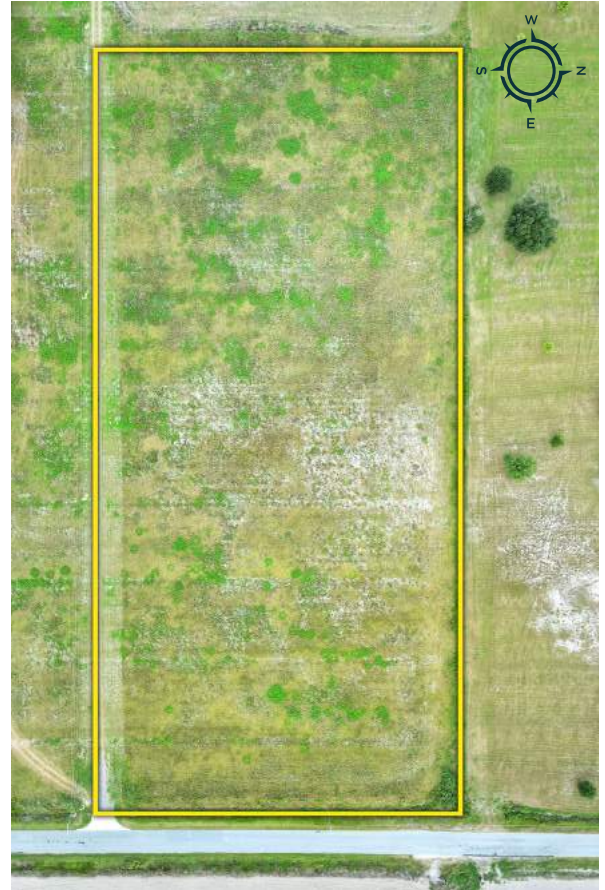

Property Address	17809 Grange Hall Loop, Wimauma, FL 33598	County	Hillsborough
Property Type	Acreage Homesites	Folio/Parcel ID	088920-0172
Size	5.43± Acres	STR	18-32-21
Zoning	AR	Utilities	Well and Septic Required
Future Land Use	AR	Road Frontage	328± feet on Grange Hall Loop
Price	\$305,000	Property Taxes	\$116.45 (2022)

Photos





Photos



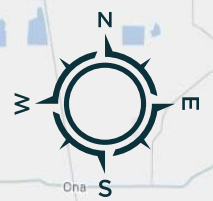
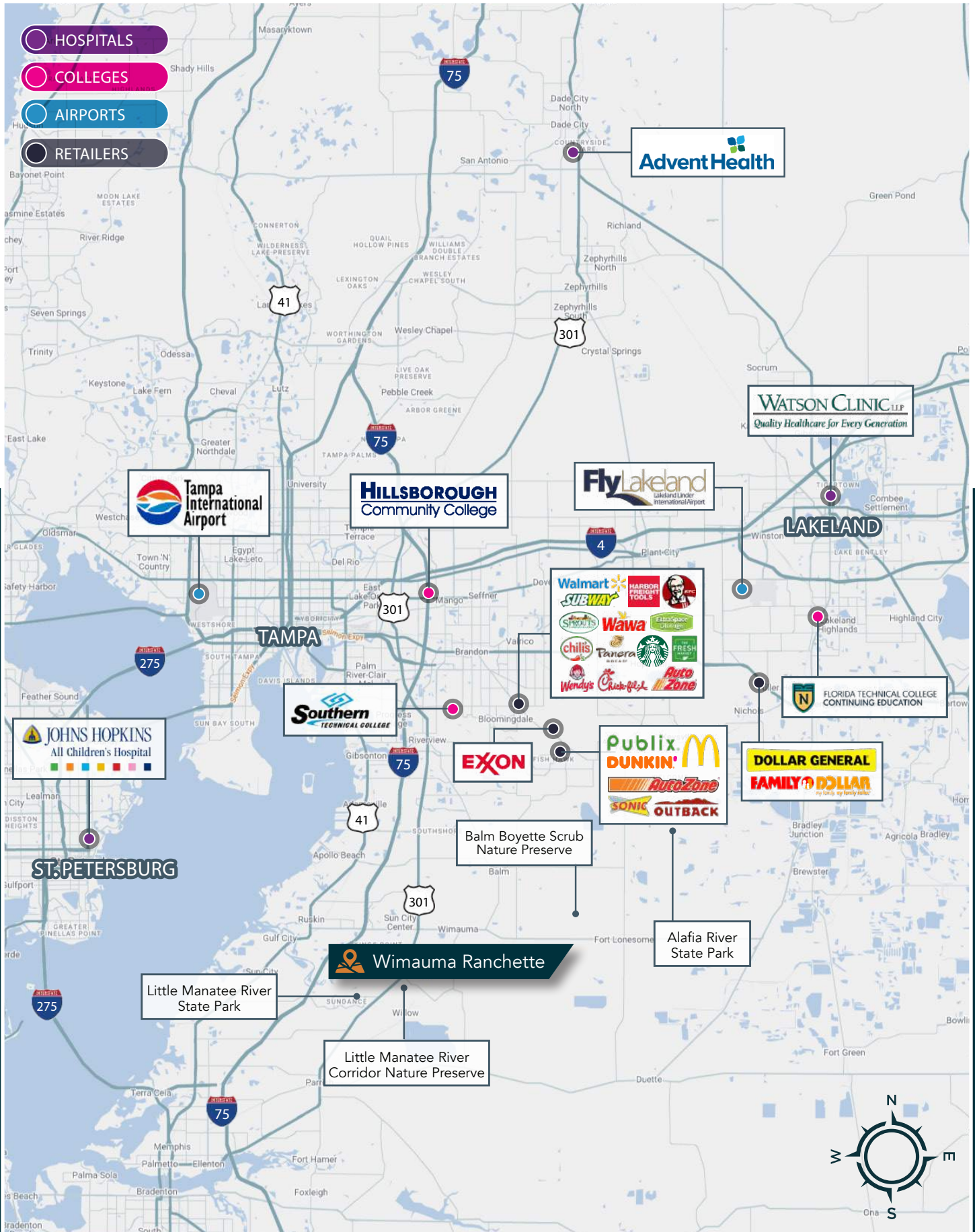

Fischbach **LAND COMPANY**

FISCHBACH LAND COMPANY

917 S PARSONS AVENUE, BRANDON, FL 33511

PHONE: 813-540-1000



BLAISE LELAULU, CCIM

blaise@fischbachlandcompany.com